

Cable accessories for «red-y smart series»

Connection of one thermal mass flow meter or controller to a PC

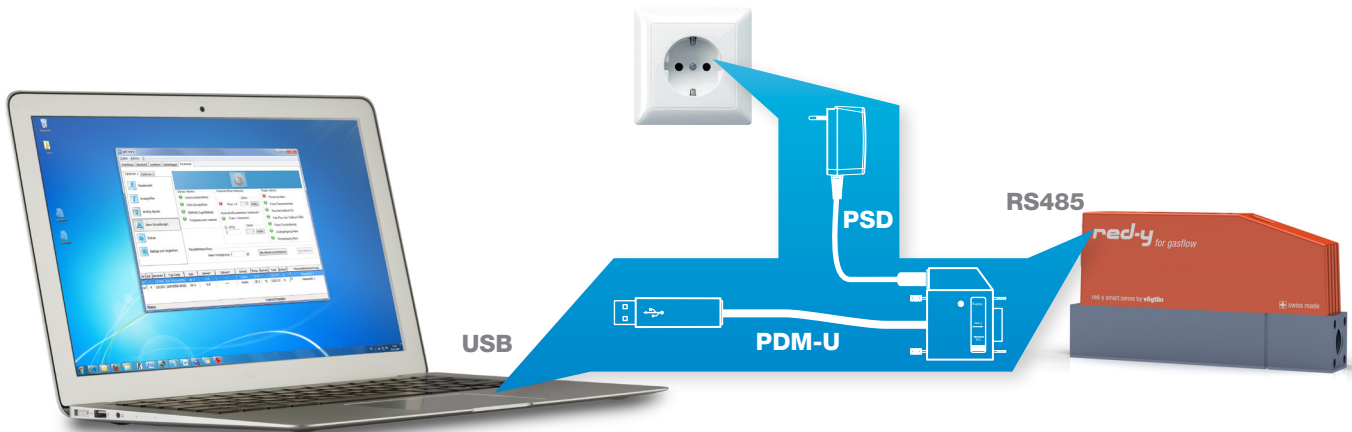

The following cables are required:

Type	Description
PDM-U 328-2180	Power Digital Module USB (1.5m) Communication cable PC/red-y (active level converter USB/RS485)
PSD	Plug-Type Power Supply Device (1.8m) Plug-type power supply 24Vdc, approx. 0.5A (12 W)

Connection of several thermal mass flow meters or controllers to a PC

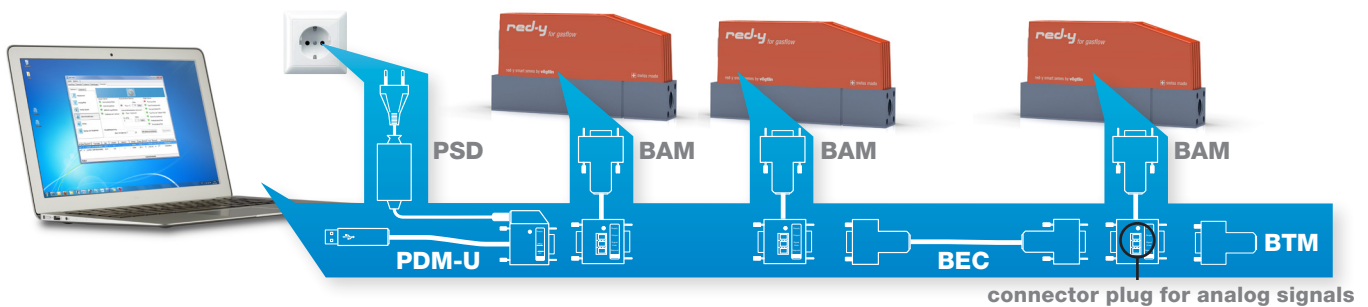

Example with 3 devices: the following cables are required

Type	Description	Quantity for above example
PDM-U 328-2180	Power Digital Module USB (1.5m) Communication cable PC/red-y (active level converter USB/RS485)	1
BAM 328-2151	Bus Analog Module (0.1m) For the connection of one device	3
BTM 328-2139	Bus Terminator Module Termination resistor for bus communication	1
PSD	Desktop Power Supply Device (2m) Desktop power supply 24Vdc, approx. 2.2A (53 W)	1

Additional extension cables (BEC) and power supplies are available: See reverse side



Overview cables & modules «red-y smart series»

PDM-U 328-2180

Power Digital Module USB (1.5m)

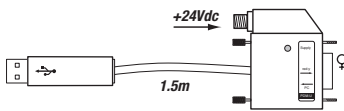

Communication cable PC/red-y galvanically separated
Active level converter USB/RS485
Powered by power supply PSD

BAM 328-2151

Bus Analog Module (0.1m)

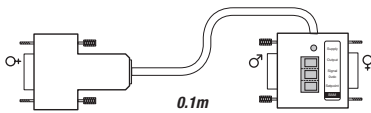

D-Sub network node, digital switch with additional connector for analog setpoint and reading signals
With pluggable screw terminal

PSM 328-2152

Power Separator Module

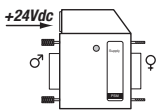

D-Sub node with connector for power supply
With isolator function to link an additional power supply PSD in the bus

BEC

Bus Extension Cable (0.5/2.0/5.0m)



Extension cable for digital communication and analog signals

Lenght	Part-No.
0.5 m	328-2160
2.0 m	328-2161
5.0 m	328-2162

BTM 328-2139

Bus Terminator Module

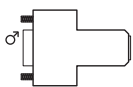

Termination resistor for bus communication
Always recommended for a bus structure!

PAC 328-2164

Power Analog Cable (3.0m)

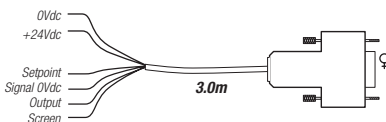

D-Sub connector with cable for connection of a PLC or similar for use with analog setpoint and reading signals of meter/controller
Loose ends with ferrules

PDC 328-2165

Power Digital Cable (3.0m)

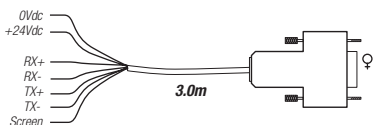

D-Sub connector with cable for connection of e.g. a PLC for digital operation of meter/controller (Modbus)
Loose ends with ferrules

PSD

Plug-Type Power Supply Device (1.8m)

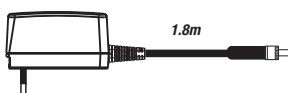

Input: 100 – 240Vac, 50 – 60Hz
Output: 24Vdc, approx. 0.5A (12W), connector with locking ring, dia. 2.1/5.5mm
Additional exchangeable primary connectors on request

Plug	Part-No.
Euro	328-2311
US	328-2312
GB	328-2313
AU/NZ	328-2314
CN	328-2315

PSD

Desktop Power Supply Device (2m)

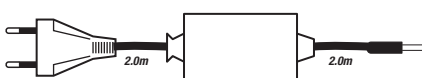

Input: 100 – 240Vac, 50 – 60Hz, 1.1A
Output: 24Vdc, approx. 2.2A (53W), dia. 2.1/5.5mm

Plug	Part-No.
Euro	328-2233
US	328-2238
GB	328-2239
AU/NZ	328-2237

PSD

Plug-Type Power Supply Device for Display SPOT / SETSPOT (1.8m)



Plug-type power supply device for direct feeding of **one** red-y smart with display option (read-out/operation via display function only)
Input: 100 – 240Vac, 50 – 60Hz
Output: 24Vdc, approx. 0.5A (12W), D-Sub connector
Additional exchangeable primary connectors on request

Plug	Part-No.
Euro	328-2321
US	328-2322
GB	328-2323
AU/NZ	328-2324
CN	328-2325